

增量式磁栅编码器 LMT

INCREMENTAL MAGNETIC ENCODER LMT

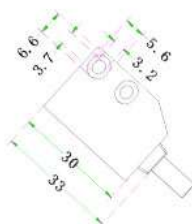
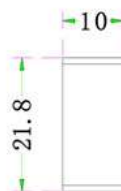
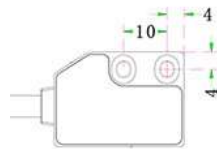

- 高系统精度, 高重复精度
High system accuracy and high repeatability
- 高分辨率, (磁距 2mm, 分辨率最小可以 0.0305um)
High resolution, (magnetic distance 2mm, minimum resolution can be 0.0305um)
- 可定制的最高输出频率, (最大输出频率可达 5000KHz)
The highest output frequency that can be customized, (the maximum output frequency can reach 5000KHz)
- 智能告错指示灯,显示编码器工作状态
Intelligent error indicator, showing the working status of the encoder
- 工业标准数字信号(A+, A-, B+, B-, Z+, Z-),标准RS422差分信号
Industry standard digital signal(A+, A-, B+, B-, Z+, Z standard RS422 differential signal)
- 高品质连接线, 编织屏蔽线, 耐折弯, 耐磨, 抗干扰
High-quality connecting wire, braided shielded wire, resistant to bending, abrasion and interference
- 非接触式测量, 耐灰尘、耐磨损、耐冲击、抗振动、抗磁场干扰
Non-contact measurement, resistant to dust, abrasion, impact, vibration, and magnetic interference
- 防护等级高, 耐油, 灰尘, 润滑剂等污染
High protection level, resistant to oil, dust, lubricants and other pollution
- 高间隙公差, 任意测量长度
High clearance tolerance, arbitrary measuring length
- 体积小, 适用于小安装空间
Small size, suitable for small installation space

特性、技术参数表、备注

特性 Features	技术参数 Technical parameters	备注 Notes
供电电压 Supply voltage	5V +/-5%	
磁间距 Magnetic distance	2+2mm	
分辨率 Resolution	0.5μm	
重复精度 Repeat accuracy	±2μm	
输出频率 Output frequency	1000KHz	
最大速度 Maximum speed	4m/S (可按客户定制) Can be customized	
线缆 Cable	8芯屏蔽线 8 core shielded wire	
接线方式 Wiring	直接出线 Straight out	
输出形式 Output form	RS422	
LED状态指示 LED status indication	红/绿色 Red / green	
电流 Electric current	小于45mA Less than 45mA	
防护等级 Protection level	IP67	
可订制参数 Customizable parameters	分辨率,输出频率,计数方向,线缆长度 Resolution, output frequency, counting direction, cable length	

机械特性:
金属铝外壳
Ø5.0 ± 0.1 mm, PUR高柔性, 屏蔽8线电缆; 耐用性

电气特性:
电缆柔性好, 耐磨
信号具有良好的稳定性
每个磁极距周期性产生零位信号
工作温度: -20°C-70°C
储存温度: -20°C-80°C

[安装和调试要点, 详见产品说明书:]

Installation and commissioning, see product specifications